



Stand construction services

General stand construction services

Save time, money and hassle designing your stand – by relying on the experience and know-how of Deutsche Messe and its service partners for modular stand construction. From simple, basic stands to high-end, deluxe solutions, we streamline your tradeshow experience for you by providing turnkey, modular stands (one or two stories high), which you can customize by selecting from our comprehensive range of additional equipment and fittings.

Tip: Our turnkey “fair package” solutions offer you even more services, including floor space, stand assembly and much more. For further information, visit: www.messe.de/fairpackage_e

Note: Since all stands are required to have a basic electric supply, our modular stands automatically come with a 3-kW power point. If you need a power point with a higher power rating, please order this via the OBS. If you require a 400 V, 3-phase machine connection, please contact us.

Contact:

Frank Zwingmann

Tel.: +49 511 89-32227

frank.zwingmann@messe.de

Modular stands

Typical stand configurations



Slim stand
Lean stand structure – just the bare minimum



Type A stand
Basic stand assembly for simple, straightforward presentations at a budget price



Type B stand
Modular stand system – the combination of modular ceiling sections and standard add-on elements offers plenty of scope for customized stand design



Type C stand
Fresh new modular stand design, with large-format graphics available even in basic version



Type D stand
Open-sided stand design, which offers an ideal presentation platform with its back-lit advertising tower topped by a rotating cube



Line stand
High-grade, innovative modular stand system, featuring glass and textile design elements even in basic version (long-range visual impact)



Double stand
The simple solution with no hidden costs for exhibitors who need a two-storey stand



Truss stand
Truss-based system – can be used to construct a modular stand (with additional fittings) or as a customized extension to any type of stand construction

Slim stand

Minimum modular stand design with no ceiling construction. Rental price for basic fittings, including assembly and dismantling: € 55 per m² and event.

Note: You'll find additional fittings for Slim stand on pages 43–45. Further furnishings on request.

Basic fittings

Carpeting

Disposable off-the-role cord carpeting, dark blue



Perimeter partition walls

to adjacent stands and/or hall walls, constructed of Octanorm elements, silver, with light grey infill panels, 250 cm high (free-standing walls that are more than 4 m in length require bracing by adding tower elements or support walls)

Tower elements

2 elements, each at open wall endings, dimensions 25 x 100 cm, 300 cm high

Lettering

Lettering on each tower infill section, approx. 45 x 95 cm, in Helvetica Bold (max. 15 characters)

1 electrical distribution box

For connections of up to 3 kW, with two integrated 230-V sockets (sockets in other locations subject to additional charge)

Attached sideboard

approx. 50 x 100 cm, 90 cm high, for storing electrical distribution box

Lighting

one 50 W spotlight per tower element



Basic fittings



Typical stand configuration with additional fittings



Typical stand configuration with additional fittings

Additional fittings for Slim stand (illustrations may vary from actual)

Wall and cabin fittings

1.1	Wall element (as for basic fittings package) 1 m element	€ 31.00
1.2	1/2 m element	€ 31.00
1.3	Reinforced infill panel (16 mm)	€ 76.80
1.4	Infill panel, colored on one side (RAL colors, hdc material) – surcharge per linear meter (rounded up to nearest meter)	€ 31.00
1.5	Door element, light grey, lockable	€ 107.00
1.6	Door element, colored on one side, lockable (RAL color) – surcharge	€ 129.60
1.7	Tower element, one-sided acrylic glass, backlit (approx. 100 x 300 cm) – surcharge	€ 300.80



1.1



1.4

Lighting

3.1	Spotlight (arm-mounted, 50 W, type basic fitting)	€ 33.90
-----	--	---------



3.1

Lettering, graphics and display media

4.1	Digital print for upper tower infill, approx. 45 x 95 cm from printable file	€ 83.20
4.2	Digital prints, printed banners, vinyl film decals	POA

Stand furnishings

5.1	Table, white, diameter 70 cm, approx. 70 cm high	€ 37.00
5.2	Table, white, 70 x 70 cm, approx. 70 cm high	€ 37.00
5.3	Table, white, 110 x 70 cm, approx. 70 cm high	€ 52.50
5.4	High table, white, diameter 70 cm, approx. 110 cm high	€ 53.80
5.5	Chair, black	€ 27.70



5.1



5.3



5.4



5.5

Stand furnishings, cont.

- | | | |
|------|---|----------|
| 5.6 | High chair/Bar stool (chrome/black) | € 42.00 |
| 5.7 | Bar counter, grey/white, lockable, 1 m element, approx. 100 x 50 cm, 108 (85) cm high | € 211.20 |
| 5.8 | Information counter, grey, lockable, approx. 100 x 50 cm, 100 cm high | € 170.20 |
| 5.9 | Sideboard, grey, lockable, approx. 90 x 42 cm, 80 cm high | € 75.00 |
| 5.10 | Literature display rack, free-standing, with 3 trays (A4 size), 120–160 cm high | € 54.40 |



5.6



5.7



5.8



5.9



5.10

Kitchen fittings and furniture

(requires kitchen cabin)

Water connections as well as electrical connections with a power rating of more than 3 kW need to be ordered separately.

- | | | |
|-----|---|----------|
| 6.1 | Kitchenette with refrigerator, sink, twin hotplates and dish draining rack, power connection approx. 7 kW, approx. 90 x 60 cm, 90 cm high | € 300.80 |
| 6.2 | Refrigerator, approx. 60 x 60 cm, 85 cm high, with freezer compartment | € 94.70 |
| 6.3 | Sink cupboard unit with built-in water heater, power connection approx. 2,5 kW, approx. 90 x 60 cm, 85 cm high | € 125.40 |
| 6.4 | Coffee maker (8-cup) | € 22.40 |
| 6.5 | Steel shelf unit, free-standing, approx. 100 x 35, 190 cm high | € 89.60 |



6.1



6.3



6.4



6.5

Display cabinets, plinths, shelving

7.1	Tabletop display cabinet, grey, lockable, approx. 100 x 50, 95 cm high	€ 170.30
7.2	Free-standing display cabinet, grey, lockable, illuminated, approx. 70 x 70 x 200 cm	€ 300.80
7.3	Free-standing display cabinet, grey, lockable, illuminated, approx. 50 x 100 x 200 cm	€ 362.20
7.4	Plinth (w x d x h), grey, approx. 50 x 50 x 50 cm	€ 39.70
7.5	Plinth (w x d x h), grey, approx. 50 x 50 x 80 cm	€ 39.70
7.6	Plinth (w x d x h), grey, approx. 50 x 50 x 100 cm	€ 51.20
7.7	Plinth (w x d x h), grey, approx. 100 x 100 x 50 cm	€ 52.50
7.8	Plinth (w x d x h), grey, approx. 100 x 100 x 80 cm	€ 52.50
7.9	Plinth (w x d x h), grey, approx. 100 x 100 x 100 cm	€ 56.30
7.10	Shelf, white, with wall brackets for level mounting, approx. 100 x 30 cm	€ 28.20
7.11	Shelf, white, with wall brackets for inclined mounting, approx. 100 x 30 cm	€ 28.20



7.1



7.2 + 7.3



7.6



7.10

Electrical installations

8.1	“Schuko” power socket, 230 V, incl. fitting/cabling	€ 20.50
8.2	“Schuko” power strip with 3 sockets, 230 V, incl. fitting/cabling	€ 25.00



8.1



8.2

Miscellaneous

9.1	Wastepaper basket	€ 5.10
9.2	Refuse bin	€ 17.90
9.3	Hourly labor charge for additional work	€ 48.60



9.1



9.2

Type A modular stand

Modular stand, recommended for smaller stand sizes. Rental price for basic fittings, including assembly and dismantling: € 75 per m² and event.

Note: You'll find additional information for Type A stands on pages 48–51. Further furnishings on request.

Basic fittings

Carpeting

disposable off-the-roll cord carpeting, available in 6 colors



Perimeter partition walls

to adjacent stands and/or hall walls, constructed of Octanorm elements, silver, with light grey infill panels, 250 cm high

Ceiling

consisting of OC frame sections along the open sides of the stand, including all necessary beams and pillar supports

Fascia panel

light grey, 200 x 40 cm, face-mounted along each open side of the stand, including black lettering in typeface Helvetica Bold (up to a maximum of 30 characters)

1 electrical distribution box

for connections of up to 3 kW, with two integrated 230-V sockets (sockets in other locations subject to additional charge)

Lighting

4 spotlights, 50 W each

Cabin

100 x 100 cm, with lockable door

1 table

diameter 70 cm or 70 x 70 cm square, with white worktop and chrome-plated underframe

3 chairs

with chrome-plated frame and black upholstery

1 coat rack

fitted inside the cabin

1 wastepaper basket



Basic fittings



Typical stand configuration with additional fittings



Typical stand configuration with additional fittings

Systemstand Typ B

Modular stand, recommended for smaller stand sizes.
Rental price for basic fittings, including assembly and dismantling: € 92 per m² and event.

Note: You'll find additional information for Type B stands on pages 48–51. Further furnishings on request.

Basic fittings

Carpeting

disposable off-the-roll cord carpeting, available in 6 colors



Perimeter partition walls

to adjacent stands and/or hall walls, constructed of Octanorm elements, silver, with light grey infill panels, 250 cm high

Ceiling

Octanorm modular sections (approx. 100 x 100 cm), silver, mounted on top of the OC system around the perimeter of the stand; height of upper edge of ceiling above floor level: 300 cm

Fascia panel

illuminated panel, approx, 150 x 40 cm, one per open aisle side, including black lettering in typeface Helvetica Bold (max. 30 letters)

1 electrical distribution box

for connections of up to 3 kW, with two integrated 230-V sockets (sockets in other locations subject to additional charge)

1 wastepaper basket

Basic fittings, depending on stand size

Stand area (m ²)	20/49	50/79	80/100
Size of cabin / No. of wall elements required: (all cabins include 1 door element, lockable)	2 m ² / 2	4 m ² / 3	6 m ² / 4
Table(s), dia. 70 cm or 70 x 70 cm*	1	2	3
Chairs*	4	8	12
Coat rack(s)	1	2	2

* You can select alternative furniture (on request) up to four weeks before the opening day of the event.



Basic fittings



Typical stand configuration with additional fittings



Typical stand configuration with additional fittings

Additional fittings for type A and B stands (illustrations may vary from actual)

Wall and cabin fittings

1.1	Wall element (as for basic fittings package) 1 m element	€ 31.00
1.2	1/2 m element	€ 31.00
1.3	Reinforced infill panel (16 mm) e.g. for mounting a monitor	€ 76.80
1.4	Infill panel, colored one side (RAL colors, hdc material) – surcharge per linear meter (rounded up to nearest meter)	€ 31.00
1.5	Infill panel, one side full-bleed printed with digital text/image from printable file – surcharge per linear meter (rounded up to nearest meter)	€ 287.00
1.6	Modular facing walls	POA
1.7	Maxima luminescent column, 300 cm, one-sided with Plexiglas, (your choice of color)	€ 115.20
1.8	Infill panel, 50 cm high (to increase wall height to 300 cm)	€ 25.50
1.9	Infill panel, colored one side, 50 cm high – surcharge	€ 10.30
1.10	Glass wall element, tinted, 1 m element	€ 95.50
1.11	Louvered blind, matches item 1.10	€ 39.70
1.12	Door element, light grey, lockable	€ 107.00
1.13	Door element, colored on one side, lockable (RAL colors) – surcharge	€ 129.60
1.14	Three and four-sided towers in various sizes	POA



1.1



1.4



1.10 + 1.11

Floor coverings/floor construction

2.1	Velour carpeting (surcharge to cord carpeting price) in 6 standard colors	€ 4.00/m ²
-----	--	-----------------------



2.2	Laminate, wood-grain finish (surcharge to cord carpeting price, only in conjunction with items 2.3 or 2.4)	€ 28.20/m ²
2.3	Chipboard flooring panels (for use with floor coverings)	€ 25.00/m ²
2.4	False floor (plinth) (for use with floor coverings)	€ 26.90/m ²



2.2



2.2

Ceiling and lighting

- 3.1 Modular ceiling sections (as for basic fittings package) 100 x 100 cm **(type B stand)** € 29.40
- 3.2 Spotlight (50 W, as for basic fittings package) € 41.00
- 3.3 Spotlight (arm-mounted, 50 W) € 33.90
- 3.4 HQI spotlight (70 W) € 61.40



3.2



3.3

Lettering, graphics and display media

The prices for items 4.3 – 4.9 **do not include any graphics**

- 4.1 Digital print for fascia, 200 x 40 cm from printable file **(type A stand)** € 128.00
- 4.2 Digital print for illuminated fascia panel, ca. 140 x 30 cm from printable file **(type B stand)** € 128.00
- 4.3 Graphics panel, approx. 100 x 100 cm mounted in front of wall panel € 33.90
- 4.4 Clip-on frame, approx. DIN A1 € 32.00
- 4.5 Digital prints, printed banners, vinyl film decals POA
- 4.6 Advertising pylon, approx. 350 cm high, **(type B stand)** € 181.80
- 4.7 Advertising pylon, approx. 350 cm high, with glass shelves **(type B stand)** € 297.00
- 4.8 Advertising pylon, approx. 350 cm high, with slide viewer (without graphics), **(type B stand)** € 341.80
- 4.9 Advertising pylon, approx. 350 cm high, with integrated display cabinet, lockable, illuminated **(type B stand)** € 501.80



4.3



4.4



4.6



4.7



4.8



4.9

Stand furnishings

- 5.1 Table (as for basic fittings package, white) diameter 70 cm, approx. 70 cm high € 37.00
- 5.2 Table (as for basic fittings package, white) 70 x 70 cm, approx. 70 cm high € 37.00
- 5.3 Table, white, 110 x 70 cm, approx. 70 cm high € 52.50
- 5.4 High table, white, diameter 70 cm, approx. 110 cm high € 53.80
- 5.5 Chair (as for basic fittings package, black) € 27.70



5.1



5.3



5.4



5.5

Stand furnishings, contd.

- | | | |
|------|--|----------|
| 5.6 | High chair/bar stool (chrome/black) | € 42.00 |
| 5.7 | Bar counter, grey/white, lockable,
1 m element, approx. 100 x 50 x 108 (85) cm | € 211.20 |
| 5.8 | Information counter, grey, lockable,
approx. 103 x 50 x 100 cm | € 170.20 |
| 5.9 | High computer table, grey,
approx. 70 x 50 x 100 cm | € 198.40 |
| 5.10 | Attached modular table, grey,
approx. 50 x 100 x 110 cm
(with wall brackets four mounting) | € 147.20 |
| 5.11 | Sideboard, grey, lockable,
approx. 90 x 42 x 80 cm | € 75.00 |
| 5.12 | Literature display rack, free-standing,
with 3 trays (A4 size), 120–160 cm high | € 54.40 |



5.6



5.7



5.8



5.9



5.10



5.11



5.12

Kitchen fittings and furniture

Water connections as well as electrical connections with a power rating of more than 3 kW need to be ordered separately.

- | | | |
|-----|--|----------|
| 6.1 | Kitchenette with refrigerator, sink,
twin hotplates and dish draining rack,
power connection approx. 7 kW,
size approx. 90 x 60 x 90 cm | € 300.80 |
| 6.2 | Refrigerator, approx. 60 x 60 x 85 cm
with freezer compartment | € 94.70 |
| 6.3 | Sink cupboard unit with built-in water
heater, power connection approx. 2.5 kW,
size approx. 90 x 60 x 85 cm | € 125.40 |
| 6.4 | Coffee maker (8-cup) | € 22.40 |
| 6.5 | Steel shelf unit, free-standing,
approx. 100 x 30 x 200 cm | € 89.60 |



6.1



6.3



6.4



6.5

Display cabinets, plinths, shelving

7.1	Tabletop display cabinet, grey, lockable, approx. 95 x 50, 100 cm high	€ 170.30
7.2	Free-standing display cabinet, grey, lockable, illuminated, approx. 70 x 70 x 200 cm	€ 300.80
7.3	Free-standing display cabinet, grey, lockable, illuminated, approx. 50 x 100 x 200 cm	€ 362.20
7.4	Plinth (w x d x h), grey, approx. 50 x 50 x 50 cm	€ 39.70
7.5	Plinth (w x d x h), grey, approx. 50 x 50 x 80 cm	€ 39.70
7.6	Plinth (w x d x h), grey, approx. 50 x 50 x 100 cm	€ 51.20
7.7	Plinth (w x d x h), grey, approx. 100 x 100 x 50 cm	€ 52.50
7.8	Plinth (w x d x h), grey, approx. 100 x 100 x 80 cm	€ 52.50
7.9	Plinth (w x d x h), grey, approx. 100 x 100 x 100 cm	€ 56.30
7.10	Shelf, white, with wall brackets for level mounting, approx. 100 x 30 cm	€ 28.20
7.11	Shelf, white, with wall brackets for inclined mounting, approx. 100 x 30 cm	€ 28.20



7.1



7.2 / 7.3



7.6



7.10

Electrical installations

8.1	“Schuko” power socket, 230 V incl. fitting/cabbling	€ 20.50
8.2	“Schuko” power strip with three sockets, 230 V incl. fitting/cabbling	€ 25.00



8.1



8.2

Miscellaneous

9.1	Wastepaper basket	€ 5.10
9.2	Refuse bin	€ 17.90
9.3	Hourly labor charge for additional work	€ 48.60



9.1



9.2

Type C modular stand

Modular stand, recommended for stand sizes of 20 m² and above. Rental price for basic fittings, including assembly and dismantling: € 108 per m² and event.

Note: You'll find additional information for Type C stands on pages 53–56. Further furnishings on request.

Basic fittings

Carpeting

disposable off-the-roll cord carpeting, available in 6 colors



Perimeter partition walls

to adjacent stands and/or hall walls, constructed of 10 cm thick wall elements, white, 250 cm high

1 electrical distribution box

for connections of up to 3 kW, with two integrated 230-V sockets (sockets in other locations subject to additional charge)

Lighting

1 spotlight (arm-mounted, 150 W) per 5 m² of stand area, plus 4 HQI spotlights (75 W) on modular stand tower

1 wastepaper basket

Basic fittings, depending on stand size

Stand area (m ²):	20/49	50/79	80/100
Size of cabin / No. of wall elements required (all cabins include 1 door element, lockable)	2 m ² / 2	4 m ² / 3	6 m ² / 4
Modular stand tower (10 x 10 cm profile) 160 cm wide, 320 cm long, 360 cm high with 1 fabric banner measuring approx. 140 x 340 cm incl. digital print (dependent on timely delivery of printable file by exhibitor)	1	1	2
Table(s), dia. 70 cm or 70 x 70 cm*	1	2	3
Chairs*	4	8	12
Coat rack(s)	1	2	2

* You can select alternative furniture (on request) up to four weeks before the opening day of the event.



Basic fittings



Typical stand configuration with additional fittings



Typical stand configuration with additional fittings

Additional fittings for type C stand (illustrations may vary from actual)

Wall and cabin fittings

1.1	Wall element (as for basic fittings package) 1 m element	€ 70.40
1.2	1/2 m element	€ 44.80
1.3	Reinforced infill panel e.g. for mounting a monitor	€ 32.00
1.4	Infill panel, colored one side – surcharge per linear meter	€ 50.60
1.5	Infill panel, one side full-bleed printed with digital text/image from printable file – surcharge per linear meter	€ 238.10
1.6	Infill panel, one-sided, with stretch fabric incl. digital print from printable file – surcharge per linear meter –	€ 121.60
1.7	Wall panel, 100 cm high (to increase wall height to 350 cm), per linear meter	€ 47.20
1.8	Infill panel, colored one side 100 cm high – surcharge per linear meter	€ 42.90
1.9	Door element, white, lockable	€ 96.00
1.10	Door element, colored on one side (RAL colors) – surcharge	€ 192.00
1.11	Free-standing wall element, white, approx. 100 x 250 cm with steel base	€ 175.20
1.12	Free-standing wall element, colored, approx. 100 x 250 cm with steel base	€ 276.40
1.13	Free-standing wall element, white, approx. 100 x 250 cm with attached table (55 x 55 x 95 cm)	€ 249.60
1.14	Free-standing wall element, white, approx. 100 x 200 cm with attached table on both sides (ea. 55 x 55 x 95 cm)	€ 324.00

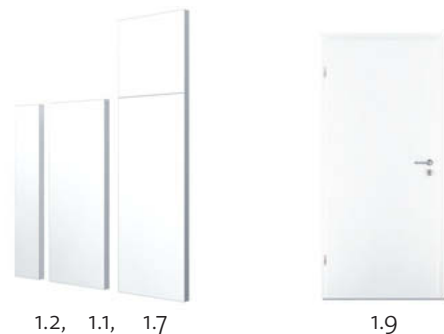

Floor coverings / floor construction

2.1	Velour carpeting in 6 standard colors (surcharge to cord carpeting price)	€ 4.00/m ²
2.2	Laminate, wood-grain finish (only in conjunction with items 2.3 or 2.4) (surcharge to cord carpeting price)	€ 28.20/m ²
2.3	Chipboard flooring panels (for use with floor coverings)	€ 25.00/m ²
2.4	False floor (plinth) (for use with floor coverings)	€ 26.90/m ²



2.2



2.2

Ceiling and lighting

- | | | |
|-----|---|----------|
| 3.1 | Modular stand tower
(as for basic fitting package) | € 765.40 |
| 3.2 | Arm-mounted spotlight, 150 Watt
(as for basic fitting package) | € 32.00 |
| 3.3 | HQI spotlight, 75 W
(as for basic fitting package) | € 46.70 |



3.2



3.3

Lettering, graphics and display media

(see also "Wall and cabin fittings")

- | | | |
|-----|--|-----|
| 4.1 | Digital prints, printed banners,
vinyl film decal | POA |
|-----|--|-----|

Stand furnishings

- | | | |
|------|---|----------|
| 5.1 | Table, chrome/white
(as for basic fitting package)
diameter 70 cm, approx. 70 cm high | € 46.10 |
| 5.2 | Table, chrome/white
(as for basic fitting package)
70 x 70 cm, approx. 70 cm high | € 46.10 |
| 5.3 | High table, rectangular, white,
140 x 60 cm, approx. 110 cm high | € 52.50 |
| 5.4 | High table, round, chrome/white,
diameter 70 cm, approx. 110 cm high | € 53.80 |
| 5.5 | Chair, chrome/white
(as for basic fitting package) | € 23.00 |
| 5.6 | High chair/bar stool
(chrome/black) | € 42.00 |
| 5.7 | High chair/bar stool
(chrome/white) | € 74.30 |
| 5.8 | Bar counter/information counter,
white, lockable | € 197.10 |
| 5.9 | Bar counter/information counter, white,
lockable, approx. 103 x 50 x 100 cm | € 227.80 |
| 5.10 | Sideboard, light grey, lockable,
approx. 90 x 40 x 85 cm | € 61.40 |
| 5.11 | High computer table, light grey,
approx. 60 x 60 x 110 cm | € 172.80 |



5.1



5.3



5.4



5.5



5.6



5.7



5.8



5.9



5.10



5.11

Stand furnishings, cont.

- 5.12 High computer table, as per item 5.11, with glass front € 224.00
- 5.13 Literature rack with 5 A4 sections, free-standing, 130 cm high € 83.20



5.12



5.13

Kitchen fittings and furniture

Water connections as well as electrical connections with a power rating of more than 3 kW need to be ordered separately.

- 6.1 Kitchenette with refrigerator, sink, twin hotplates and dish draining rack, power connection approx. 7 kW, size approx. 90 x 60 x 90 cm € 300.80
- 6.2 Refrigerator, approx. 60 x 60 x 85 cm with freezer compartment € 94.70
- 6.3 Sink cupboard unit with built-in water heater, power connection approx. 2.5 kW, size approx. 90 x 60 x 85 cm € 125.40
- 6.4 Coffee maker (8-cup) € 22.40
- 6.5 Steel shelf unit, free-standing approx. 100 x 30 x 200 cm € 57.60



6.1



6.3



6.4



6.5

Display cabinets, plinths, shelving

- 7.1 Tabletop display cabinet, grey, lockable, approx. 100 x 50 x 90 cm € 101.10
- 7.2 Free-standing display cabinet, grey, lockable, illuminated, approx. 50 x 50 x 200 cm € 183.70
- 7.3 Free-standing display cabinet, grey, lockable, illuminated, approx. 50 x 100 x 200 cm € 230.40
- 7.4 Plinth (w x d x h), light grey with glass cover, approx. 40 x 40 x 110 cm € 54.40
- 7.5 Plinth, light grey, approx. 40 x 40 x 90 cm € 41.60



7.1



7.2



7.3



7.4

Display cabinets, plinths, shelving, cont.

7.6	Plinth, light grey, approx. 50 x 50 x 50 cm	€ 33.90
7.7	Plinth, light grey, approx. 100 x 100 x 50 cm	€ 74.20
7.8	Plinth, light grey, approx. 100 x 100 x 90 cm	€ 89.00
7.9	Shelf, white, with wall brackets for level mounting, approx. 100 x 30 cm	€ 28.80
7.10	Shelf, white, with wall brackets for inclined mounting, approx. 100 x 30 cm	€ 28.80



7.9

Electrical installations

8.1	“Schuko” power socket, 230 V incl. fitting/cabling	€ 20.50
8.2	“Schuko” power strip with three sockets, 230 V incl. fitting/cabling	€ 25.00



8.1



8.2

Miscellaneous

9.1	Wastepaper basket	€ 5.10
9.2	Refuse bin	€ 17.90
9.3	Hourly labor charge for additional work	€ 48.60



9.1



9.2

Type D modular stand

Modular stand, recommended for stand sizes of 20 m² and above. Rental price for basic fittings, including assembly and dismantling: € 115 per m² and event.

Note: You'll find additional information for Type D stands on pages 58–61. Further furnishings on request.

Basic fittings

Carpeting



Perimeter partition walls

to adjacent stands and/or hall walls, constructed of 40 cm thick wall elements, light grey, 250 cm high

1 electrical distribution box

for connections of up to 3 kW, with two integrated 230-V sockets (sockets in other locations subject to additional charge)

2 ceiling frame sections

of varying lengths (for connecting the advertising tower)

Lighting

one 150 W spotlight per 3 m² of floor space

1 wastepaper basket

Basic fittings, depending on stand size

Stand area (m ²):	20/49	50/79	80/100
Size of cabin / No. of wall elements required (all cabins include 1 door element, lockable)	4 m ² / 3	8 m ² / 5	10 m ² / 6
Advertising tower, 50 x 50 x 350 cm, partially backlit with rotating cube (50 x 50 cm), incl. 4-sided cube print ¹⁾ and lettering on tower panels in standard typeface Helvetica Bold (max. 40 characters per tower)	1	2	2
Table(s), dia. 70 cm or 70 x 70 cm*	1	2	3
Chairs*	4	8	12
Coat rack(s)	1	2	2

* You can select alternative furniture (on request) up to four weeks before the opening day of the event.

¹⁾ Dependent on timely delivery of printable file by exhibitor, at least four weeks before opening day of event.



Basic fittings



Typical stand configuration with additional fittings



Typical stand configuration with additional fittings

Additional fittings for type D stand (illustrations may vary from actual)

Wall and cabin fittings

- | | | |
|-----|--|----------|
| 1.1 | Wall element, light grey
(as for basic fittings package) 1 m element | € 37.80 |
| 1.2 | 1/2 m element | € 34.60 |
| 1.3 | Wall panel, colored one side (RAL colors)
– surcharge per linear meter – | € 64.00 |
| 1.4 | Wall element, 100 cm high
(to increase wall height to 350 cm),
cost per linear meter | € 23.70 |
| 1.5 | Wall panel, colored one side
(RAL colors) 100 cm high
– surcharge per linear meter – | € 34.60 |
| 1.6 | Glass wall element,
tinted, 1 m element | € 199.70 |
| 1.7 | Louvered blind,
matches item 1.6 | € 35.80 |
| 1.8 | Door element, lockable | € 122.90 |
| 1.9 | Door element, colored on one side
(RAL colors) – surcharge | € 171.10 |



1.1



1.3



1.6



1.6 + 1.7

Floor coverings / floor construction

- | | | |
|-----|--|-----------------------|
| 2.1 | Velour carpeting in 6 standard colors
(surcharge to cord carpeting price) | € 4.00/m ² |
|-----|--|-----------------------|



- | | | |
|-----|---|------------------------|
| 2.2 | Laminate, wood-grain finish
(only in conjunction with items 2.3 or 2.4)
(surcharge based on cord carpeting) | € 28.20/m ² |
|-----|---|------------------------|

- | | | |
|-----|---|------------------------|
| 2.3 | Chipboard flooring panels
(for use with floor coverings) | € 25.00/m ² |
|-----|---|------------------------|

- | | | |
|-----|--|------------------------|
| 2.4 | False floor (plinth)
(for use with floor coverings) | € 26.90/m ² |
|-----|--|------------------------|



2.2



2.2

Ceiling and lighting

- | | | |
|-----|---|---------|
| 3.1 | Ceiling frame section (as for basic
fittings package), cost per linear meter | € 21.10 |
| 3.2 | Spotlight, arm-mounted, 150 W
(as for basic fittings package) | € 53.10 |
| 3.3 | Spotlight, track-mounted,
150 W cold light source | € 56.00 |



3.2

Lettering, graphics and display media

The following prices do not include graphics

4.1	Graphics panel, approx. 100 x 100 cm	€ 33.30
4.2	Clip-on frame, approx. 85 x 85 cm	€ 41.00
4.3	Digital prints, printed banners, vinyl film decals	POA
4.4	Advertising tower with rotating element (as for basic fittings package) 50 x 50 x 350 cm	€ 202.20
4.5	Advertising tower, light grey, 50 x 100 x 350 cm	€ 239.40



4.1



4.2



4.5

Stand furnishings

5.1	Table (chrome/white, as for basic fittings package) diameter 70 cm	€ 48.60
5.2	Table (chrome/white, as for basic fittings package) 70 x 70 cm	€ 41.00
5.3	Table, rectangular	€ 43.50
5.4	High table, chrome/white, diameter 60 cm	€ 57.60
5.5	PC counter, lockable	€ 204.80
5.6	Chair (aluminum/white, as for basic fittings package)	€ 33.30
5.7	High chair/bar stool, aluminum/white	€ 42.90
5.8	Bar counter, 1 m element, lockable	€ 225.30
5.9	Information counter, 1 m element, lockable	€ 202.20
5.10	Sideboard, lockable	€ 71.70
5.11	Literature display rack, with 3 A4 sections, wall-mounted	€ 37.10
5.12	Literature display rack, with 5 A4 sections, free-standing	€ 53.80



5.1



5.4



5.5



5.7



5.8



5.9



5.11



5.12

Kitchen fittings and furniture

Water connections as well as electrical connections with a power rating of more than 3 kW need to be ordered separately.

- | | | |
|-----|--|----------|
| 6.1 | Kitchenette with refrigerator, sink, twin hotplates and dish draining rack, power connection approx. 4.5 kW, size approx. 90 x 60 x 90 cm) | € 300.80 |
| 6.2 | Refrigerator, approx. 60 x 60 x 85 cm with freezer compartment | € 94.70 |
| 6.3 | Sink cupboard unit with built-in water heater, power connection approx. 2.2 kW, size approx. 90 x 60 x 85 cm | € 125.40 |
| 6.4 | Coffee maker (8-cup) | € 22.40 |
| 6.5 | Shelf unit, free-standing, approx. 100 x 30 x 200 cm | € 87.00 |



6.1



6.3



6.4



6.5

Display cabinets, plinths, shelving

- | | | |
|------|---|----------|
| 7.1 | Tabletop display cabinet, lockable, 99 x 53 x 91 cm | € 172.80 |
| 7.2 | Free-standing display cabinet, lockable, illuminated, approx. 50 x 50 x 200 cm | € 209.90 |
| 7.3 | Free-standing display cabinet, lockable, illuminated, approx. 50 x 100 x 200 cm | € 263.70 |
| 7.4 | Plinth (w x d x h) approx. 50 x 50 x 50 cm | € 39.70 |
| 7.5 | Plinth (w x d x h) approx. 50 x 50 x 75 cm | € 39.70 |
| 7.6 | Plinth (w x d x h) approx. 50 x 50 x 100 cm | € 51.20 |
| 7.7 | Plinth (w x d x h) approx. 100 x 100 x 50 cm | € 52.50 |
| 7.8 | Plinth (w x d x h) approx. 100 x 100 x 75 cm | € 52.50 |
| 7.9 | Plinth (w x d x h) approx. 100 x 100 x 100 cm | € 56.30 |
| 7.10 | Shelf, with wall brackets for level mounting, 100 x 30 cm | € 34.60 |
| 7.11 | Shelf, with wall brackets for inclined mounting, 100 x 30 cm | € 46.10 |



7.1



7.2



7.6

Electrical installations

- 8.1 "Schuko" power socket, 230 V
incl. fitting/cabling € 20.50
- 8.2 "Schuko" power strip with 3 sockets,
230 V, incl. fitting/cabling € 25.00



8.1



8.2

Miscellaneous

- 9.1 Wastepaper basket € 5.10
- 9.2 Refuse bin € 17.90
- 9.3 Hourly labor charge for additional work € 48.60



9.1



9.2

Truss stand

Available as a modular stand element or as an extension or module for any type of stand construction.

Note: : The truss system (without any installations or additional fittings) is also available for outdoor use/ open-air site. Prices are available on request.

We'll be happy to provide you with further information on additional fittings and furniture for Truss stands. Stated rental prices cover basic fittings for the duration of a single event and include assembly and dismantling.

Stated rental prices cover basic fittings for the duration of a single event and include assembly and dismantling.

Enclosed area	Price
12 to 30 m ²	€ 67.00/m ²
31 to 60 m ²	€ 49.00/m ²
61 to 100 m ²	€ 40.00/m ²
101 to 150 m ²	€ 35.00/m ²
up to 300 m ²	€ 32.00/m ²
over 300 m ²	POA

Basic fittings

Truss system

supported on 4 corner columns, including all necessary bracings, overall height approx. 350 cm (height extension subject to surcharge)

Lighting

1 spotlight (150 W) per 5 m² of stand area

1 electrical distribution box

for connections of up to 3 kW, with two integrated 230-V sockets (sockets in other locations subject to additional charge)

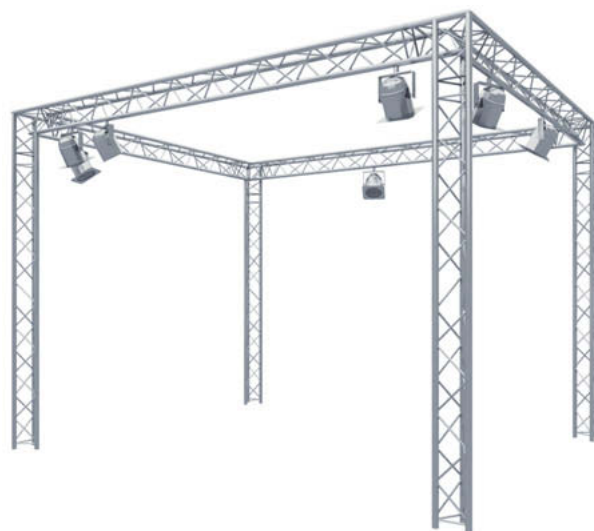

Basic fittings



Typical stand configuration with additional fittings



Typical stand configuration with additional fittings

Line stand

High-grade Modular stand, recommended for stand sizes of 30 m² and above. Rental price for basic fittings, including assembly and dismantling: € 135 per m² and event.

Note: We'll be happy to provide you with further information about additional fittings and furniture for Line stands.

Basic fittings

Carpeting

disposable off-the-roll cord carpeting, available in 6 colors



Perimeter partition walls

to adjacent stands and/or hall walls, light grey (Leitner system), grid module 200 cm wide, overall height: 300 cm

Ceiling framing profiles

form a 200 x 200 cm grid, including all necessary bracings and pillar supports

Graphics panel/Ceiling construction

200 x 300 cm frame assembly with glass infill panel, 8 mm thick, incl. lettering in standard typeface Helvetica Bold (up to a maximum of 20 characters)
 200 x 200 cm, 100 cm high graphics cube with 4-sided fabric infill, incl. digital print¹⁾ on 1, 2, 3 or 4 sides (depending on number of open stand sides)

Lighting

1 spotlight (100 W) per 3 m² of stand area

1 electrical distribution box

for connections of up to 3 kW, with two integrated 230-V sockets (sockets in other locations subject to additional charge)

1 wastepaper basket

Basic fittings, depending on stand size

Stand area (m ²)	30/59	60/89	90/150
Size of cabin (incl. 1 door element, lockable)	2 m ²	6 m ²	8 m ²
Coat rack(s)	1	2	2

¹⁾ Dependent on timely delivery of printable file by exhibitor, at least four weeks before opening day of event.



Basic fittings



Typical stand configuration with additional fittings



Typical stand configuration with additional fittings

Double stand

Platform staging, with stairs, for the construction of two-storey stands in four fixed sizes and configurations, including certified structural calculations.

Note: We'll be happy to provide you with further information about additional fittings and furniture for Double stands.

Basic fittings

Steel staging

with flooring panels on upper storey, white casing for supports, circumferential white fascia panel

Balustrade

on all sides at first-floor level, hand rail in beech wood

Staircase

one flight, steps in beech multiplex design

Lighting

suspended ceiling with one 50 W spotlight/downlight per 1 m² of enclosed ground-floor area

1 electrical distribution box

For connections of up to 3 kW, with two integrated 230-V sockets (sockets in other locations subject to additional charge). The connection to the Exhibition Center power grid must be rented separately.



Basic fittings



Typical stand configuration with additional fittings



Typical stand configuration with additional fittings

Stated rental prices cover basic fittings for the duration of a single event and include assembly and dismantling.

Additional charges:

1. € 400 fee for approval of structural assembly
2. rental for additional usable floor space on upper story, as detailed below

17 m² usable area on upper floor
€ 8,772

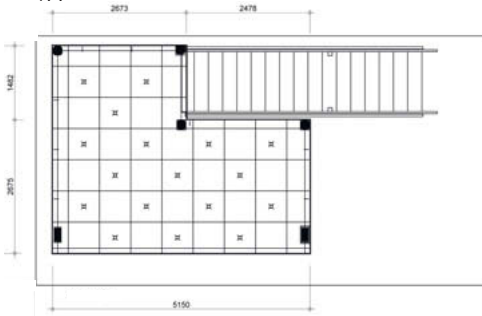

31 m² usable area on upper floor
€ 12,958

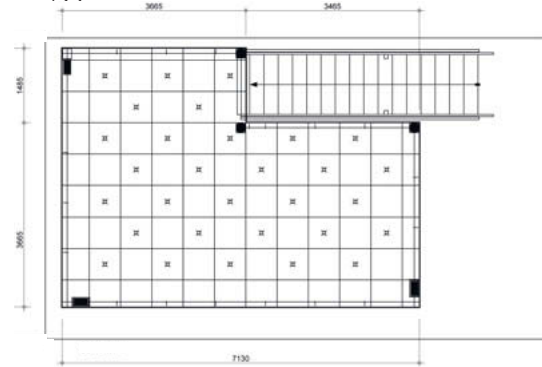

45 m² usable area on upper floor
€ 15,660

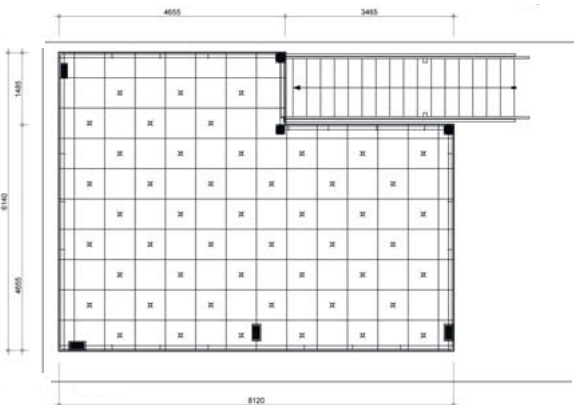

53 m² usable area on upper floor
€ 17,172

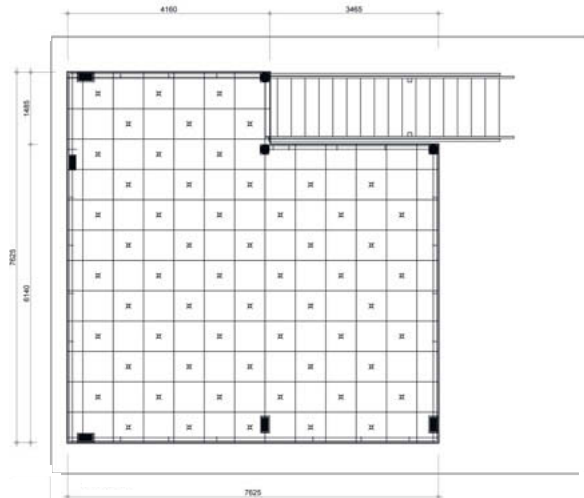

Overall height:

